

RURAL MUNICIPALITY OF ST. ANDREWS

BY-LAW NO. 4271

Being a By-Law of the Rural Municipality of St. Andrews to authorize the Expenditure and Borrowing of money for the completion of a new regional wastewater collection system to service the southern portion of the R.M. of St. Andrews (Phase 1) as a Local Improvement.

WHEREAS Section 311 of *The Municipal Act*, S.M. 1996, C.58, provides in part as follows:

If approved by by-law, a municipality may undertake, as a local improvement for the benefit of all or part of the municipality,

- (a) the acquisition, development, upgrading or replacement of one or more of the following:
 - (i) sewage collection and treatment facilities;
 - (ii) water supply, treatment and distribution facilities;
 - (iii) waste management facilities;
 - (iv) highways;
 - (v) drainage systems; or
- (b) any other project the cost of which includes a capital component.

AND WHEREAS subsection 320(1) of *The Municipal Act* provides as follows:

Subject to subsection (2) to (6) and subsection 321(4), a Council may by by-law

- (a) approve the local improvement or special service as set out in the plan or proposal; and
- (b) authorize the municipality to impose taxes as set out in the plan or proposal.

AND WHEREAS Section 172 of *The Municipal Act* provides in part as follows:

In this Division,

"Borrowing" means the borrowing of money, and includes

- (b) borrowing to pay for a local improvement under Division 4 (Local Improvements and Special Services) of Part 10,
- (e) issuing debentures

AND WHEREAS, the Council of the Rural Municipality of St. Andrews has prepared Local Improvement Plan No. 2016-01 providing for the spending, borrowing authority, and imposition of taxes for the the completion a new regional wastewater collection system to service the southern portion of the R.M. of St. Andrews (Phase 1). The wastewater will be conveyed via the Main Street Trunk Sewer in West St. Paul for treatment at the North End Water Pollution Control Centre in Winnipeg as a local improvement pursuant to Part 10 of *The Municipal Act*,

AND WHEREAS, in order to complete such undertaking, it will be necessary for the Rural Municipality of St. Andrews to borrow the sum of \$6,924,429. as hereinafter provided, which is the amount of the debt intended to be created by this by-law;

AND WHEREAS the consecutive annual amounts, including principal and interest, required to be raised each year for 20 years, as hereinafter provided, for paying the principal and interest under this by-law are the amounts set out in Schedule "A" hereto;

AND WHEREAS the requirements are prescribed in Sections 318, 319 and 320 of *The Municipal Act* have been complied with;

AND WHEREAS the assessed value of the whole lands chargeable under this by-law according to the latest revised Assessment Roll is \$55,030,800;

AND WHEREAS the amount of the existing borrowing debt of the Rural Municipality of St. Andrews is \$0 of which no portion of the principal or of the interest thereon is in arrears;

NOW THEREFORE the Council of the Rural Municipality of St. Andrews in Special session assembled, enacts as follows:

1. That pursuant to subsection 320(1) of *The Municipal Act*, Rural Municipality of St. Andrews adopt Local Improvement Plan No. 2016-01 attached hereto as Schedule "B".
2. That the Rural Municipality of St. Andrews may expend up to Fifteen Million, One Hundred Eighty Five Thousand and Three Hundred and Seventeen dollars (\$15,185,317.) for the purpose of completing of a new regional wastewater collection system to service the southern portion of the R.M. of St. Andrews. The wastewater will be conveyed via the Main Street Trunk Sewer in West St. Paul for treatment at the North End Water Pollution Control Centre in Winnipeg as a local improvement.
3. That for the aforesaid project, the said municipality may borrow up to Six Million, Nine Hundred Twenty Four Thousand and Four Hundred and Twenty-nine dollars (\$6,924,429.), such borrowing shall be issued by the Rural Municipality of St. Andrews in the Province of Manitoba, and shall be payable at the Sunova Credit Union in Selkirk, Canada at the holder's option, and shall be dated the 31st day of August, 2017.
4. That the said borrowing shall bear interest at a rate estimated for the time being at 5.5% per annum, and subject in any event to the authorization of The Municipal Board at the time of sale, and shall mature in accordance with the maturities set out in Schedule "A" hereto on the 31st day of December in each of the years 2018 to 2037, both inclusive.
5. That the issuance of borrowings shall be signed by the Mayor or by some other person authorized by by-law to sign same, and by the Chief Administrative Officer of the Rural Municipality of St. Andrews and there shall be affixed thereto the corporate seal of the said municipality.
6. That during the currency of the said borrowing; namely, in each of the years 2018 to 2037, both inclusive, there shall be raised annually by a per parcel rate on all the rateable property in the Rural Municipality of St. Andrews described in Schedule "C" hereto, an amount sufficient to provide the principal and interest requirements hereunder.
7. That pursuant to subsection 174(3) (d) of *The Municipal Act*, pending the issue of the borrowing, the Council of the Rural Municipality of St. Andrews may agree with a bank or person or borrow from the general funds of the municipality for temporary advances from time to time to meet expenditures incurred for the purpose aforesaid, and the total of such advances shall not exceed Six Million, Nine Hundred Twenty Four Thousand and Four Hundred and Twenty-nine dollars (\$6,924,429.).
8. That, at any time prior to or within (30) days following completion of the work, any ratepayer of the area affected by the local improvement as described in Schedule "C" hereto may commute and pay in one principal sum that part of his/her share of the debt herein authorized in respect of the frontage and/or flankage OR per parcel rate(s) provided herein to the said Chief Administrative Officer of the Rural Municipality of St. Andrews and thereafter no frontage and/or flankage OR per parcel rate(s) shall be levied against his/her said lands in respect of the borrowing to be authorized herein.

Done and Passed by a by-law of the Rural Municipality of St. Andrews in the Province of Manitoba this ____ day of _____, 2016.

Mayor

Chief Administrative Officer

Read a first time this 28th day of June, A.D. 2016
 Read a second time this ____ day of ____ A.D. 2016
 Read a third time this ____ day of ____ A.D. 2016

Certified a True Copy of By-Law No. 4271

Andrew Weremy, Chief Administrative Officer

RURAL MUNICIPALITY OF ST. ANDREWS

SCHEDULE - A TO BYLAW NO.4271

Local Improvement Debenture Issue

| | | | |
|--------------------|--------------|--------------------------------------|--------------|
| Term (Yrs): | 20 | Amount: | 6,924,429.00 |
| Date: | None Entered | Rate (%): | 5.5000 |
| Payable: | None Entered | Annual Payment: | 579,431.58 |
| | | First Year's Payment: | 579,431.58 |
| | | Adjusted Last Year's Payment: | 579,431.62 |

MATURITY SCHEDULE

| Year | Interest | Principal | Balance |
|---------------|---------------------|---------------------|----------------|
| 1 | 380,843.60 | 198,587.98 | 6,725,841.02 |
| 2 | 369,921.26 | 209,510.32 | 6,516,330.70 |
| 3 | 358,398.19 | 221,033.39 | 6,295,297.31 |
| 4 | 346,241.35 | 233,190.23 | 6,062,107.08 |
| 5 | 333,415.89 | 246,015.69 | 5,816,091.39 |
| 6 | 319,885.03 | 259,546.55 | 5,556,544.84 |
| 7 | 305,609.97 | 273,821.61 | 5,282,723.23 |
| 8 | 290,549.78 | 288,881.80 | 4,993,841.43 |
| 9 | 274,661.28 | 304,770.30 | 4,689,071.13 |
| 10 | 257,898.91 | 321,532.67 | 4,367,538.46 |
| 11 | 240,214.62 | 339,216.96 | 4,028,321.50 |
| 12 | 221,557.68 | 357,873.90 | 3,670,447.60 |
| 13 | 201,874.62 | 377,556.96 | 3,292,890.64 |
| 14 | 181,108.99 | 398,322.59 | 2,894,568.05 |
| 15 | 159,201.24 | 420,230.34 | 2,474,337.71 |
| 16 | 136,088.57 | 443,343.01 | 2,030,994.70 |
| 17 | 111,704.71 | 467,726.87 | 1,563,267.83 |
| 18 | 85,979.73 | 493,451.85 | 1,069,815.98 |
| 19 | 58,839.88 | 520,591.70 | 549,224.28 |
| 20 | 30,207.34 | 549,224.28 | 0.00 |
| TOTALS | 4,664,202.64 | 6,924,429.00 | |

23-Apr-16

SCHEDULE “B” TO BY-LAW NO. 4271

Installation of Sewer Services – Phase 1 Local Improvement Plan – (LID #1) – No. 2016-01 Pursuant to Section 315 of *The Municipal Act*

A. Description of the Proposed Local Improvement:

The local improvement plan proposed herein involves the provision of authority to construct and borrow funds for the completion of a new regional wastewater collection system to service the southern portion of the R.M. of St. Andrews (Phase 1). The wastewater will be conveyed via the Main Street Trunk Sewer in West St. Paul for treatment at the North End Water Pollution Control Centre in Winnipeg.

The project has been initiated by the Council of the R.M. of St. Andrews to provide a cost-effective means of treating wastewater while protecting the health of the community located within *the Manitoba Conservation Red River Corridor Designated Area* that was established in 2009 by Provincial Regulation. This Regulation prohibits the replacement or modification of existing septic fields and construction of new septic fields in the Corridor.

The Onsite Wastewater Management System Regulation of *The Environment Act* of Manitoba states in part as follows:

“Requirement to connect to new wastewater collection system

8.1(1) If a wastewater collection system is installed in an area not previously serviced by a wastewater collection system, an owner of land in that area must

- (a) connect his or her wastewater sources to the wastewater collection system; and
- (b) take any onsite wastewater management system or privy located on the land out of service and decommission it; before the earlier of
- (c) the passing of a period of five years from the day that the wastewater collection system was installed; or
- (d) the transfer or subdivision of the land.”

Phase 1 of the project is the construction of a regional wastewater forcemain from Riversprings Drive in West St. Paul to River Road in the R.M. of St. Andrews, a Lift Station and Odour Control System at River Road and low pressure lines throughout the Phase 1 service area.

Part 1 of the project is the construction of a regional wastewater forcemain from Riversprings Drive in West St. Paul to the south boundary of the R.M. of St. Andrews. The project includes the forcemain, a Lift Station at River Road and an Odour Control System. This portion of the project is referred to as the “GAP” and the costs of the forcemain only will be funded by Phase 1 and Phase 2 (north of Liss Road to the area south of Lower Fort Garry) equally. A map of the area included in Phase 1 and Phase 2 of the project is identified in Section I.

Part 2 of the project is the local servicing of all properties located in Phase 1 - south of Liss Road and east of CP Railway with a low-pressure sewer system. The properties will be required to connect within five (5) years once the wastewater system has been commissioned.

All work on private property and the connection cost to the City of Winnipeg (approximately \$2,300.00) will be paid directly by the property owner at the time of connection.

B. Identification of the local improvement district (LID #1):

The local improvement district will include all properties in the municipality other than property described in Section 21 of *The Municipal Assessment Act*.

C. Identification of the potential taxpayers:

The potential taxpayers will be the property owners of all taxable, grant-in-lieu and otherwise exempt properties in the municipality that are located in the area described as Phase 1 in the Rural Municipality of St. Andrews and are described in Schedule “C”.

D. Method and Rate for calculation of the proposed local improvement tax:

The method to be used for calculating the proposed local improvement tax will be based on an amount for each parcel of land on property that is real property, described in Schedule "C".

The rate will be:

Finance cost - \$618.39 per annum (based on one (1) lot) for the years 2018 to 2037

Or a

Lump-sum cost (pre-payment amount) of \$7,390.00 per one (1) lot due and payable on a date set by Council.

Pursuant to section 325 of *The Municipal Act*, all taxpayers will be offered the option to pre-pay their portion of the local improvement tax by a date set by Council.

E. Estimated Cost:

The total estimated cost of the local improvement is as follows:

Part 1:

| | |
|---|--------------------|
| Total GAP Cost | \$4,601,317 |
| Less: Manitoba Water Services Board Grant | <u>\$2,250,000</u> |
| Cost to be allocated to Phase 1 & 2 | <u>\$2,351,317</u> |
| Phase 1 – 79% of the total cost | \$1,840,429 |
| Phase 2 – 21% of the total cost | \$ 510,888 |

Part 2:

| | |
|--|----------------------------|
| Lower Pressure Sewer | \$10,584,000 |
| Less: Canada/Manitoba Infrastructure Grant | \$ 4,000,000 |
| Less: Manitoba Water Services Board Grant | <u>\$ 1,500,000</u> |
| Cost to be allocated to Phase 1 | <u>\$ 5,084,000</u> |

Phase 1:

| | |
|------------------------------------|----------------------------|
| Part 1 – GAP Cost | \$ 1,840,429 |
| Part 2 – Lower Pressure Sewer Cost | <u>\$ 5,084,000</u> |
| Total Phase 1 cost | <u>\$ 6,924,429</u> |

F. Source of funding:

The Council of the Rural Municipality of St. Andrews has secured funding from Canada/Manitoba Infrastructure and the Manitoba Water Services Board.

G. Estimated amount of money to be borrowed:

| | |
|-----------------|---------------|
| Amount: | \$6,924,429 |
| Maximum rate: | 5.5% interest |
| Term: | 20-year term |
| Annual payment: | \$579,431.58 |

H. Annual funding:

The annual operation or maintenance of the local improvement will be funded through revenues received from the levy charged to customers of the sewer utility.

I. Map of area including Phase 1 and Phase 2:

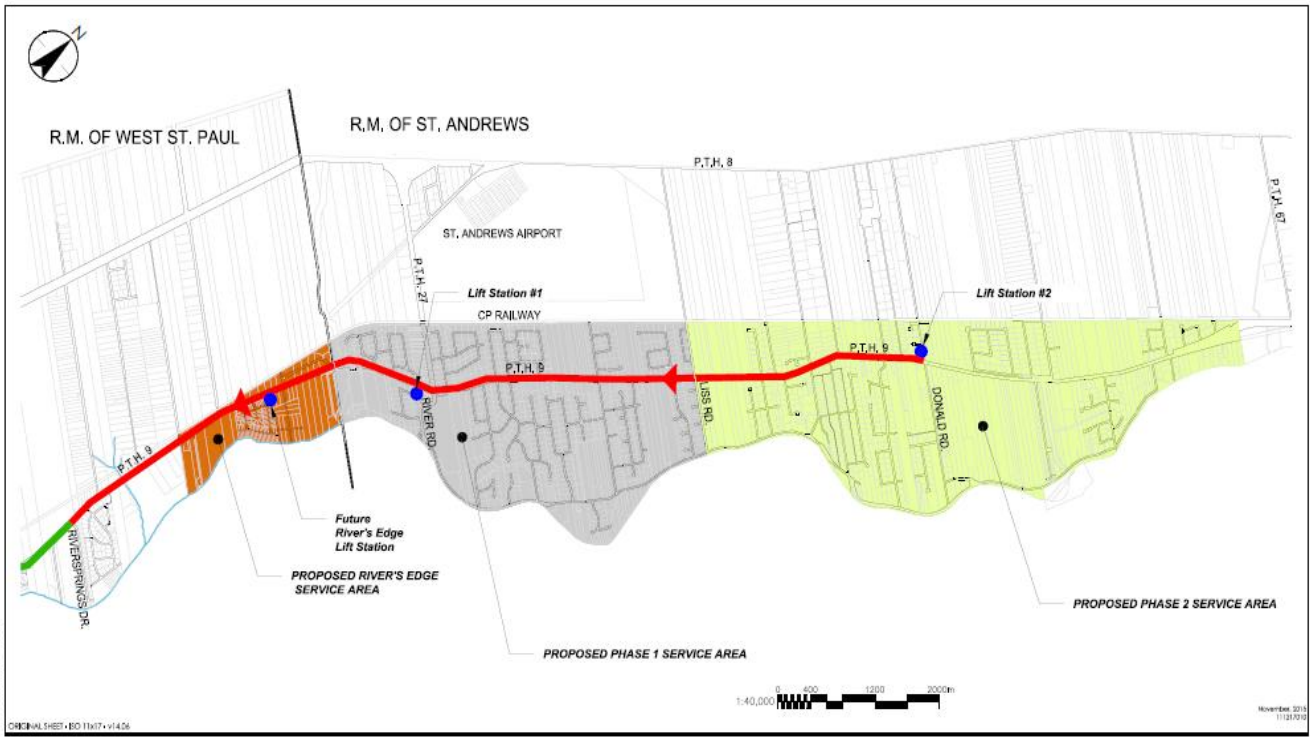

Stantec
 Stantec Consulting Ltd.
 Suite 500, 311 Portage Avenue
 Winnipeg MB Canada R3B 2B9
 Tel. 204.489.5900 Fax. 204.453.9012
 www.stantec.com

Legend
 EXISTING TRUNK SEWER
 PROPOSED FORCEMAIN

Notes

Client/Project
 THE MANITOBA WATER SERVICES BOARD
 SOUTH ST. ANDREWS REGIONAL
 WASTEWATER SEWER PROJECT
 Figure No.
 Fig. 1.0
 SERVICE AREA

Rural Municipality of St. Andrews

Andrew Weremy, Chief Administrative Officer

SCHEDULE "C" TO BY-LAW NO. 4271
Installation of Sewer Services – Phase 1
Local Improvement Plan – (LID #1) – No. 2016-01
Pursuant to Section 315 of *The Municipal Act*

Finance cost \$618.39 per annum (based on one (1) lot) for the years 2018 to 2037

Or a

Lump-sum cost (pre-payment amount) of \$7,390.00 per one (1) parcel of land on property located in the area described as Phase 1 in the Rural Municipality of St. Andrews due and payable on a date set by Council.

On the following properties:

| | | | | |
|------|------|------|------|------|
| 100 | 1602 | 2800 | 6400 | 6553 |
| 200 | 1603 | 2825 | 6450 | 6554 |
| 300 | 1604 | 2850 | 6501 | 6555 |
| 500 | 1605 | 2860 | 6502 | 6556 |
| 550 | 1606 | 2870 | 6503 | 6557 |
| 600 | 1607 | 2900 | 6504 | 6558 |
| 700 | 1608 | 3000 | 6505 | 6559 |
| 800 | 1609 | 3100 | 6506 | 6560 |
| 1000 | 1610 | 3200 | 6507 | 6561 |
| 1115 | 1611 | 3300 | 6508 | 6562 |
| 1117 | 1612 | 3400 | 6509 | 6563 |
| 1119 | 1613 | 3500 | 6510 | 6564 |
| 1300 | 1614 | 3600 | 6511 | 6565 |
| 1301 | 1615 | 3690 | 6512 | 6566 |
| 1302 | 1616 | 3700 | 6513 | 6568 |
| 1303 | 1617 | 3720 | 6514 | 6600 |
| 1304 | 1618 | 3730 | 6515 | 6610 |
| 1305 | 1619 | 3750 | 6516 | 6620 |
| 1306 | 1620 | 3760 | 6517 | 6621 |
| 1307 | 1621 | 3770 | 6518 | 6622 |
| 1308 | 1622 | 3780 | 6519 | 6623 |
| 1309 | 1623 | 3800 | 6520 | 6624 |
| 1310 | 1624 | 3900 | 6521 | 6625 |
| 1311 | 1625 | 4000 | 6522 | 6626 |
| 1312 | 1626 | 4100 | 6523 | 6627 |
| 1313 | 1627 | 4200 | 6524 | 6628 |
| 1314 | 1628 | 4300 | 6525 | 6629 |
| 1315 | 1629 | 4400 | 6526 | 6630 |
| 1316 | 1630 | 4500 | 6527 | 6631 |
| 1317 | 1631 | 4600 | 6528 | 6632 |
| 1318 | 1905 | 4700 | 6529 | 6633 |
| 1319 | 1910 | 4800 | 6530 | 6634 |
| 1320 | 1915 | 4900 | 6531 | 6635 |
| 1321 | 1917 | 4950 | 6532 | 6636 |
| 1322 | 1920 | 5000 | 6533 | 6637 |
| 1323 | 1925 | 5050 | 6534 | 6638 |
| 1324 | 1930 | 5100 | 6535 | 6639 |
| 1325 | 1935 | 5200 | 6536 | 6640 |
| 1326 | 1940 | 5300 | 6537 | 6641 |
| 1327 | 1945 | 6151 | 6538 | 6642 |
| 1328 | 1950 | 6152 | 6539 | 6643 |
| 1331 | 1955 | 6153 | 6540 | 6644 |
| 1350 | 1960 | 6154 | 6541 | 6645 |
| 1355 | 1965 | 6155 | 6542 | 6646 |
| 1360 | 1970 | 6156 | 6543 | 6647 |
| 1590 | 1975 | 6157 | 6544 | 6648 |
| 1591 | 1976 | 6158 | 6545 | 6649 |
| 1592 | 2000 | 6159 | 6546 | 6650 |
| 1593 | 2300 | 6160 | 6547 | 6651 |
| 1594 | 2320 | 6161 | 6548 | 6652 |
| 1595 | 2326 | 6162 | 6549 | 6653 |
| 1596 | 2330 | 6163 | 6550 | 6654 |
| 1600 | 2600 | 6164 | 6551 | 6655 |
| 1601 | 2700 | 6165 | 6552 | 6656 |

| | | | | |
|--------|------|------|-------|-------|
| 6657 | 7980 | 9390 | 9736 | 10400 |
| 6658 | 7982 | 9395 | 9737 | 10700 |
| 6659 | 7983 | 9400 | 9738 | 10720 |
| 6660 | 7984 | 9450 | 9739 | 10730 |
| 6661 | 8000 | 9500 | 9740 | 10900 |
| 6662 | 8002 | 9505 | 9741 | 11000 |
| 6663 | 8004 | 9520 | 9742 | 11200 |
| 6664 | 8006 | 9522 | 9743 | 11300 |
| 6665 | 8008 | 9524 | 9744 | 11600 |
| 6665.1 | 8010 | 9526 | 9745 | 11700 |
| 6666 | 8012 | 9528 | 9746 | 11800 |
| 6667 | 8014 | 9530 | 9747 | 11815 |
| 6668 | 8016 | 9532 | 9748 | 11825 |
| 6669 | 8018 | 9534 | 9749 | 11850 |
| 6670 | 8020 | 9536 | 9750 | 11857 |
| 7400 | 8022 | 9538 | 9751 | 11859 |
| 7425 | 8024 | 9540 | 9752 | 12100 |
| 7600 | 8026 | 9542 | 9753 | 12200 |
| 7700 | 8028 | 9544 | 9754 | 12300 |
| 7705 | 8030 | 9546 | 9755 | 12305 |
| 7710 | 8032 | 9548 | 9756 | 12310 |
| 7715 | 8034 | 9550 | 9757 | 12315 |
| 7720 | 8036 | 9552 | 9758 | 12320 |
| 7725 | 8038 | 9554 | 9759 | 12325 |
| 7730 | 8040 | 9556 | 9760 | 12330 |
| 7735 | 8042 | 9558 | 9761 | 12335 |
| 7740 | 8044 | 9560 | 9762 | 12340 |
| 7800 | 8046 | 9562 | 9763 | 12345 |
| 7801 | 8048 | 9563 | 9764 | 12350 |
| 7900 | 8050 | 9564 | 9765 | 12355 |
| 7902 | 8052 | 9565 | 10000 | 12360 |
| 7904 | 8054 | 9566 | 10100 | 12365 |
| 7906 | 8056 | 9600 | 10200 | 12370 |
| 7908 | 8058 | 9700 | 10250 | 12375 |
| 7910 | 8060 | 9701 | 10255 | 12380 |
| 7912 | 8062 | 9702 | 10257 | 12384 |
| 7914 | 8200 | 9703 | 10259 | 12385 |
| 7916 | 8205 | 9704 | 10261 | 12386 |
| 7918 | 8210 | 9705 | 10263 | 12387 |
| 7920 | 8225 | 9706 | 10265 | 12388 |
| 7922 | 8250 | 9707 | 10267 | 12390 |
| 7924 | 8300 | 9708 | 10269 | 12392 |
| 7926 | 8400 | 9709 | 10271 | 12394 |
| 7928 | 8500 | 9710 | 10273 | 12395 |
| 7930 | 8750 | 9711 | 10275 | 12396 |
| 7932 | 8760 | 9712 | 10277 | 12398 |
| 7934 | 8770 | 9713 | 10279 | 12400 |
| 7936 | 8800 | 9714 | 10281 | 12402 |
| 7938 | 8820 | 9715 | 10283 | 12404 |
| 7940 | 8840 | 9716 | 10285 | 12406 |
| 7942 | 8850 | 9717 | 10287 | 12408 |
| 7944 | 8900 | 9718 | 10289 | 12410 |
| 7946 | 9140 | 9719 | 10291 | 12412 |
| 7948 | 9150 | 9720 | 10293 | 12414 |
| 7950 | 9200 | 9721 | 10295 | 12416 |
| 7952 | 9300 | 9722 | 10297 | 12418 |
| 7954 | 9325 | 9723 | 10299 | 12420 |
| 7956 | 9330 | 9724 | 10301 | 12422 |
| 7958 | 9335 | 9725 | 10303 | 12424 |
| 7960 | 9340 | 9726 | 10305 | 12426 |
| 7962 | 9345 | 9727 | 10307 | 12460 |
| 7964 | 9350 | 9728 | 10309 | 12500 |
| 7966 | 9355 | 9729 | 10311 | 12640 |
| 7968 | 9360 | 9730 | 10313 | 12650 |
| 7970 | 9365 | 9731 | 10315 | 12700 |
| 7972 | 9370 | 9732 | 10317 | 12710 |
| 7974 | 9375 | 9733 | 10319 | 12800 |
| 7976 | 9380 | 9734 | 10321 | 12900 |
| 7978 | 9385 | 9735 | 10323 | 12950 |

| | | | | |
|-------|-------|-------|-------|-------|
| 12952 | 17900 | 21486 | 22600 | 23490 |
| 12954 | 18000 | 21487 | 22700 | 23495 |
| 12956 | 18100 | 21488 | 22800 | 23500 |
| 13000 | 18200 | 21489 | 22850 | 23505 |
| 13050 | 18300 | 21490 | 23000 | 23510 |
| 13100 | 18400 | 21491 | 23050 | 23600 |
| 13125 | 18500 | 21544 | 23100 | 23700 |
| 13200 | 18600 | 21546 | 23202 | 23800 |
| 13300 | 18700 | 21548 | 23203 | 23900 |
| 13400 | 18750 | 21550 | 23204 | 24000 |
| 13500 | 18800 | 21552 | 23206 | 24050 |
| 13600 | 18900 | 21554 | 23208 | 24100 |
| 13700 | 19000 | 21556 | 23210 | 24102 |
| 13800 | 19090 | 21558 | 23212 | 24104 |
| 13810 | 19100 | 21560 | 23214 | 24106 |
| 13820 | 19200 | 21562 | 23216 | 24108 |
| 13850 | 19300 | 21564 | 23218 | 24110 |
| 13860 | 19400 | 21566 | 23220 | 24112 |
| 13862 | 19500 | 21568 | 23222 | 24114 |
| 13900 | 19600 | 21570 | 23224 | 24116 |
| 14000 | 19700 | 21572 | 23226 | 24118 |
| 14100 | 19800 | 21574 | 23228 | 24120 |
| 14200 | 19900 | 21576 | 23230 | 24122 |
| 14300 | 20000 | 21578 | 23232 | 24124 |
| 14400 | 20150 | 21580 | 23234 | 24126 |
| 14500 | 20160 | 21582 | 23236 | 24128 |
| 14600 | 20170 | 21584 | 23238 | 24130 |
| 14700 | 20210 | 21586 | 23240 | 24132 |
| 14800 | 20220 | 21588 | 23242 | 24134 |
| 14900 | 20230 | 21590 | 23244 | 24136 |
| 14990 | 20240 | 21592 | 23246 | 24138 |
| 15000 | 20250 | 21594 | 23248 | 24140 |
| 15200 | 20300 | 21600 | 23250 | 24205 |
| 15300 | 20310 | 21800 | 23252 | 24207 |
| 15400 | 21402 | 21801 | 23254 | 24209 |
| 15500 | 21404 | 21802 | 23256 | 24211 |
| 15580 | 21410 | 21803 | 23258 | 24213 |
| 15590 | 21420 | 21804 | 23260 | 24215 |
| 15600 | 21440 | 21805 | 23262 | 24217 |
| 15700 | 21460 | 21806 | 23264 | 24219 |
| 15800 | 21461 | 21807 | 23266 | 24221 |
| 15900 | 21462 | 21808 | 23268 | 24223 |
| 16000 | 21463 | 21809 | 23270 | 24225 |
| 16050 | 21464 | 21810 | 23272 | 24227 |
| 16200 | 21465 | 21811 | 23274 | 24229 |
| 16210 | 21466 | 21812 | 23276 | 24231 |
| 16250 | 21467 | 21813 | 23278 | 24382 |
| 16260 | 21468 | 21814 | 23400 | 24384 |
| 16300 | 21469 | 21815 | 23405 | 24386 |
| 16400 | 21470 | 21816 | 23410 | 24388 |
| 16500 | 21471 | 21817 | 23415 | 24390 |
| 16600 | 21472 | 21818 | 23420 | 24392 |
| 16700 | 21473 | 21819 | 23425 | 24394 |
| 16800 | 21474 | 21820 | 23430 | 24396 |
| 16850 | 21475 | 21840 | 23435 | 24398 |
| 16900 | 21476 | 21850 | 23440 | 24400 |
| 17000 | 21477 | 21875 | 23445 | 24410 |
| 17100 | 21478 | 21900 | 23450 | 24420 |
| 17200 | 21479 | 22100 | 23455 | 24500 |
| 17300 | 21480 | 22200 | 23460 | 24600 |
| 17400 | 21481 | 22250 | 23465 | 24650 |
| 17500 | 21482 | 22300 | 23470 | 24700 |
| 17600 | 21483 | 22400 | 23475 | |
| 17700 | 21484 | 22450 | 23480 | |
| 17800 | 21485 | 22500 | 23485 | |